

# NORTHALL VILLAGE TRUST

Registered Charity No. 1117673



## AGM

**Friday 30th June 2017**

AGM June 2017

# NORTHALL VILLAGE TRUST – AGM 2017

## Agenda

- 1. Welcome** Alan Tipper
- 2. Apologies** Alan Tipper
- 3. Minutes of the AGM held on 12.06.2016** Alan Tipper
- 4. Trustees Annual Report for 2016** Alan Tipper
- 5. Accounts for the year ended 31.12.16** Kevin Cabbage
- 6. Election of Management Committee** Alan Tipper
- 7. Any Other Business** Alan Tipper

## 4. Trustees Annual Report for 2016

### NORTHALL VILLAGE HALL MANAGEMENT COMMITTEE

#### Our Mission

*To provide Northall (and local area) residents with a village hall that is suitable for community groups and family parties for up to 60 people and which is amongst the best for cleanliness, décor, equipment, facilities, safety - and value for money*

## **4. Trustees Annual Report for 2016**

### **Hiring Fees**

- **Fees increased from £5.00 to £5.50 for regular users w.e.f. 1<sup>st</sup> January 2016**
- **Fees increased from £6.50 to £7.00 for Ad Hoc users w.e.f. 1<sup>st</sup> January 2016**
- **On the 1<sup>st</sup> October 2016 a new higher booking fee of £12 per hour was introduced for people living outside the villages of Edlesborough, Eaton Bray, Dagnall and Northall**
- **Lowest village hall hiring fees in area**

## 4. Trustees Annual Report for 2016

<b><u>Hall Usage &amp; Hiring Income</u></b>	<b>2015</b>	<b>2016</b>	<b>% Change over 2015</b>
Hall Usage (Hrs) (Regular)	904	930	+2.9%
Hall Usage (Hrs) (Ad Hoc)	424	543	+28%
Hiring Income (£) (Regular)	4,600	5,223	+13.5%
Hiring Income (£) (Ad Hoc)	3,211	4,359	+35.8%

## 4. Trustees Annual Report for 2016

### Book Library/ Swap



**£15.20 raised towards the cost of bedding plants/Spring bulbs for Village Hall grounds. Funds available for plants currently stands at £7.87**

## **4. Trustees Annual Report for 2016**

### **PV Solar Panels**



**2016 was the first full year of ‘Feed in Tariff’ income and £1,235 was earned by the solar panel installation.**

## 4. Trustees Annual Report for 2016

### Village Hall Grounds

**The grounds are regularly maintained by the employment of a professional contractor, one volunteer gardener and the Village Hall Committee**





## 4. Trustees Annual Report for 2016 Kitchen Extension/Renovation

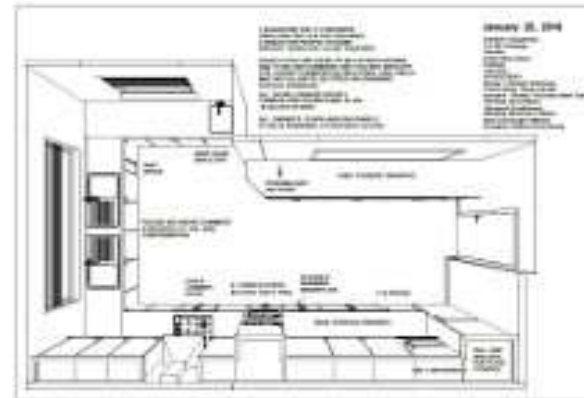

**Grant application to AVDC Community Chest for £17,192 was approved in September 2016.**

**Grant application to WREN for £39,000 was declined.**

**Decision taken by Village Hall Committee to re-apply to WREN for reduced grant of approx. £36,000.**

**If successful likely date for completion will be September 2018.**

## 4. Trustees Annual Report for 2016

### AGM 2016 Barbecue/picnic/Fun Day



**The AGM was held on Sunday the 12<sup>th</sup> June and was combined with a barbecue/picnic/fun day which proved to be very successful and was well attended by local residents. The event produced a small profit of £188.**

## 4. Trustees Annual Report 2016

### Soft Play Equipment

**The Soft Play Equipment has proved to be increasingly popular and contributed the sum of £410 an increase of 28% over 2015 in respect of hiring fees towards the hall's income.**



## Key Issues & Future Plans

- **Continue driving Vision of making NVH one of “...*the best for cleanliness, décor, equipment, facilities, safety - and value for money*”**
- **Extension, refurbishment and modernisation of the kitchen to include new sink, cooker and fridge. The Committee is currently re-applying for a grant from WREN.**
- **Sensory garden in area on the south side of the hall.**

# NORTHALL VILLAGE TRUST – AGM 2017

## Agenda

- 1. Welcome** Alan Tipper
- 2. Apologies** Alan Tipper
- 3. Minutes of the AGM held on 8.7.2015** Alan Tipper
- 4. Trustees Annual Report for 2015** Alan Tipper
- 5. Accounts for the year ended 31.12.2016** Kevin Cabbage
- 6. Election of Management Committee** Alan Tipper
- 7. Any Other Business** Alan Tipper

## 5. Accounts for the year ended 31<sup>st</sup> December 2016

### Income

2015		2016
7,811	Hall Lettings	9,582
6	Interest on Reserve A/C	4
-	PV Project-FIT Payments received	1,235
<u>26</u>	Donations - Cash received by NVHMC	<u>1,263</u>
<b>7,843</b>		<b>12,084</b>

## Expenditure

<b>2015</b>		<b>2016</b>
<b>43</b>	<b>Fixtures, Fittings, Equipment &amp; Furniture</b>	<b>1,356</b>
<b>2,908</b>	<b>Repairs &amp; Maintenance</b>	<b>251</b>
<b>1,417</b>	<b>Cleaning &amp; Materials</b>	<b>1597</b>
<b>1,294</b>	<b>Electricity (Light &amp; Heat) + Water</b>	<b>1,346</b>
<b>24</b>	<b>AGM/Barbecue</b>	<b>738</b>
<b>387</b>	<b>Printing, Postage, Stationery, Tel; PRS; Sundries</b>	<b>549</b>
<b>656</b>	<b>Insurance</b>	<b>671</b>
<b>1,254</b>	<b>Kitchen Extension</b>	<b>-</b>
<b>13,030</b>	<b>Solar Panels</b>	<b>300</b>
<hr/>		<hr/>
<b>21,013</b>		<b>6,808</b>

<b>2015</b>		<b>2016</b>
<b>7,843</b>	<b>Income</b>	<b>12,083</b>
<b>21,013</b>	<b>Expenditure</b>	<b>6,808</b>
<hr/>		<hr/>
<b>-13,170</b>	<b>Surplus/Deficit Income over Expenditure</b>	<b>5,275</b>
<b>24,363</b>	<b>Surplus B/F from previous year</b>	<b>11,193</b>
<hr/>		<hr/>
<b>11,193</b>	<b>Surplus C/F</b>	<b>16,468</b>
<hr/>		<hr/>



**Represented by:**

**2015**

**2016**

**20 Petty Cash**

**34**

**3,210 NatWest - Current A/C**

**8,467**

**7,963 - Reserve A/C (Building, Playground & Operating Reserves)**

**7,967**

---

**11,193**

---

---

---

**16,468**

---

---

# NVT Reserves Policy

- **Operating Reserves**, equivalent to 12 months minimum expenditure (currently £4,000), as a contingency against losing Regular Users, economic recession, fall in hiring income etc.
- **Building Reserves** of £3,000 to carry out emergency repairs, emergency replacement of essential equipment etc.
- **Sinking Fund** for the on-going improvement of the fabric, décor and facilities of the Hall (£3,000).
- **Possible Hall improvement projects** planned over the next few years (£6,000).

# BALANCE SHEET FOR THE YEAR ENDED 31<sup>ST</sup> DECEMBER 2016

£

## Fixed Assets:

**Land** (Price paid when purchased in 1981) **2,000**

**Hall, Storage Building & Car park**  
(Current insured value) **273,414**

**Hall Equipment & Furniture**  
(Current insured value) **14,896**

**PV Solar Panels** **12,730**

**Play Area Equipment & Seats** (current insured value) **68,760**

**Total Fixed Assets** **371,800**

# BALANCE SHEET FOR THE YEAR ENDED 31<sup>ST</sup> DECEMBER 2016

**Total Fixed Assets** 371,800

## **Current Assets**

**Stocks** - no stocks are held -

**Debtors** - as these Accounts have been prepared on a 'Receipts & Payments' basis, there are no Debtors -

**Bank & Cash** - as per 'Receipts & Payments' 16,468

16,468

## **Current Liabilities**

**Creditors** - as these Accounts have been prepared on a 'Receipts & Payments' basis, there are no Creditors -

**Net Current Assets** 16,468

**TOTAL ASSETS** 388,268

**NOTES TO THE ACCOUNTS FOR THE YEAR ENDED 31<sup>ST</sup>  
DECEMBER 2016**

**Donations from Edlesborough Parish Council  
towards the cost of running NVH & Play Area**

**2015**

(Nett of VAT)

**2016**

(Nett of VAT)









<b>313.41</b>	<b>Play Equipment Insurance</b>	<b>321.43</b>
<b>80.00</b>	<b>RoSPA Annual Safety Inspection and Report</b>	<b>108.33</b>
<b>1,253.00</b>	<b>Grass and Hedge Cutting of Hall Grounds &amp; Play Area</b>	<b>1,373.00</b>
<b>545.00</b>	<b>Emergency Exit Lights in Storage Building</b>	<b>-</b>
<hr/> <b>2,191.41</b> <hr/>	<b>Total Donations where Edlesborough Parish Council paid the Suppliers direct and recovered the VAT</b>	<hr/> <b>1,802.76</b> <hr/>

# NORTHALL VILLAGE TRUST-AGM 2017

## Agenda

- 1. Welcome** Alan Tipper
- 2. Apologies** Alan Tipper
- 3. Minutes of the AGM held on 13.7.14** Alan Tipper
- 4. Trustees Annual Report for 2015** Alan Tipper
- 5. Accounts for the year ended 31.12.2015** Kevin Cabbage
- 6. Election of Management Committee** Alan Tipper
- 7. Any Other Business** Alan Tipper

## 6. Election of Management Committee

<b>Committee Member</b>	<b>Since</b>	<b>Representing</b>	<b>Current Office</b>	<b>Willing to continue</b>
<b>Alan Tipper</b>	<b>2005</b>		<b>Chairman</b>	
<b>Kevin Cabbage</b>	<b>1989</b>	<b>Edlesborough Parish Council</b>	<b>Treasurer</b>	
<b>Lorna Cabbage</b>	<b>1982</b>	<b>Parochial Church Council</b>	<b>Bookings' Secretary</b>	
<b>Richard Dorrance</b>	<b>2006</b>		<b>Secretary</b>	
<b>Mike Scott</b>	<b>2009</b>			<b>X</b>
<b>Meurnyn Thomas</b>	<b>2014</b>	<b>Age Concern</b>		
<b>Anthony Cox</b>	<b>Jul 2014</b>	<b>Northall Baptist Chapel</b>		
<b>Sarah Pratt</b>	<b>June 2016</b>			
<b>Richard Harpley</b>	<b>May 2017</b>			

# NORTHALL VILLAGE TRUST – AGM 2016

## Agenda

- 1. Welcome** Alan Tipper
- 2. Apologies** Alan Tipper
- 3. Minutes of the AGM held on 13.7.2014** Alan Tipper
- 4. Trustees Annual Report for 2015** Alan Tipper
- 5. Accounts for the year ended 31.12.15** Kevin Cabbage
- 6. Election of Management Committee** Alan Tipper
- 7. Any Other Business** Alan Tipper



# NORTHALL VILLAGE TRUST

Registered Charity No. 1117673

